



Garden State Pavilions

Cherry Hill, NJ

Philadelphia-Camden-Wilmington (PA-NJ-DE-MD)



Michael Reigner

Leasing Representative

(410) 427-4442

mreigner@kimcorealty.com



Garden State Pavilions

Cherry Hill, NJ

www.kimcorealty.com/116640

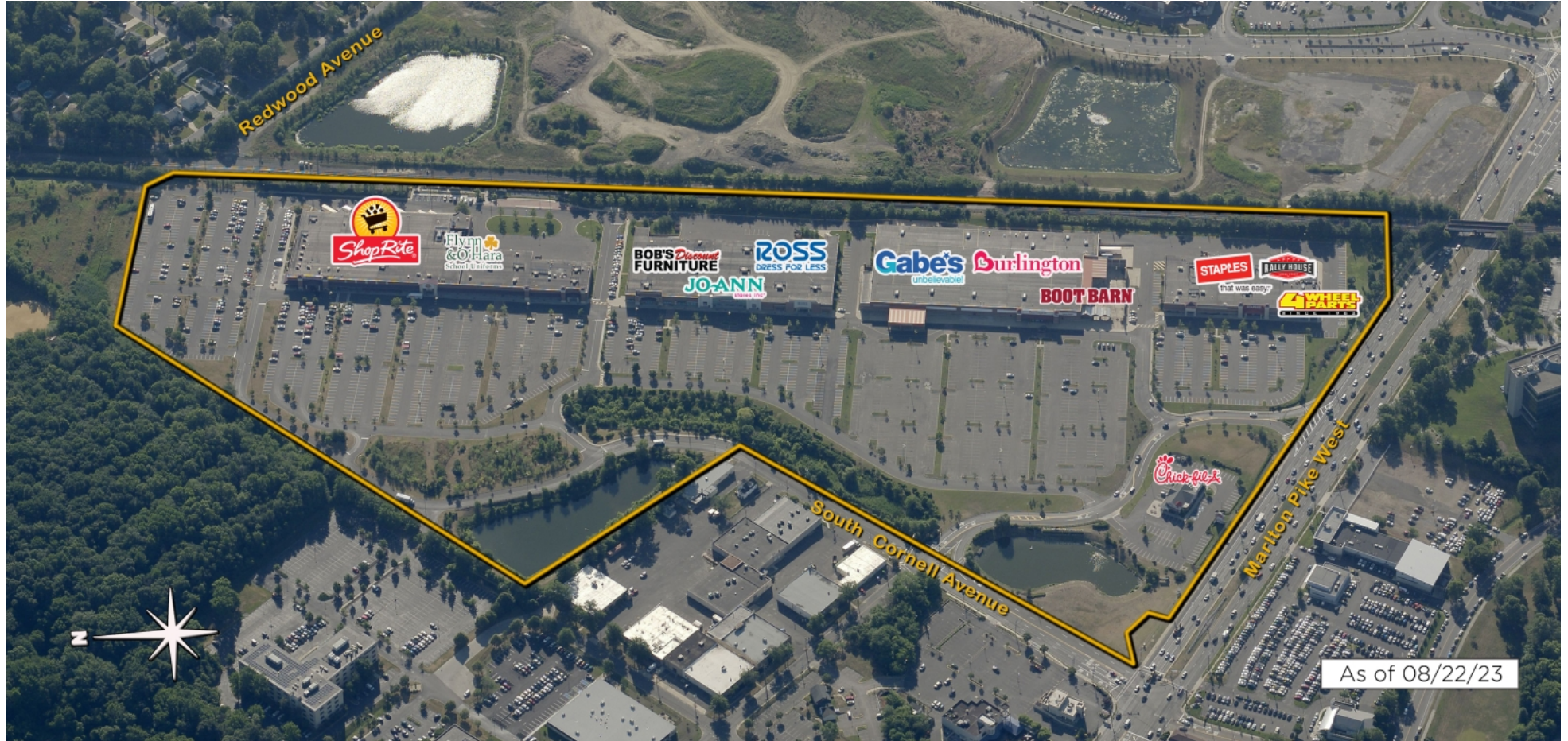

AERIAL



GROSS LEASABLE AREA (GLA)	381,020 SF
PARKING SPACES	2,995
PARKING RATIO	7.86 per 1,000 SF

Michael Reigner

Leasing Representative | (410) 427-4442 | mreigner@kimcorealty.com



Garden State Pavilions

Cherry Hill, NJ

www.kimcorealty.com/116640



DENSITY AERIAL

Michael Reigner

Leasing Representative | (410) 427-4442 | mreigner@kimcorealty.com



Garden State Pavilions

Cherry Hill, NJ

www.kimcorealty.com/116640

Available

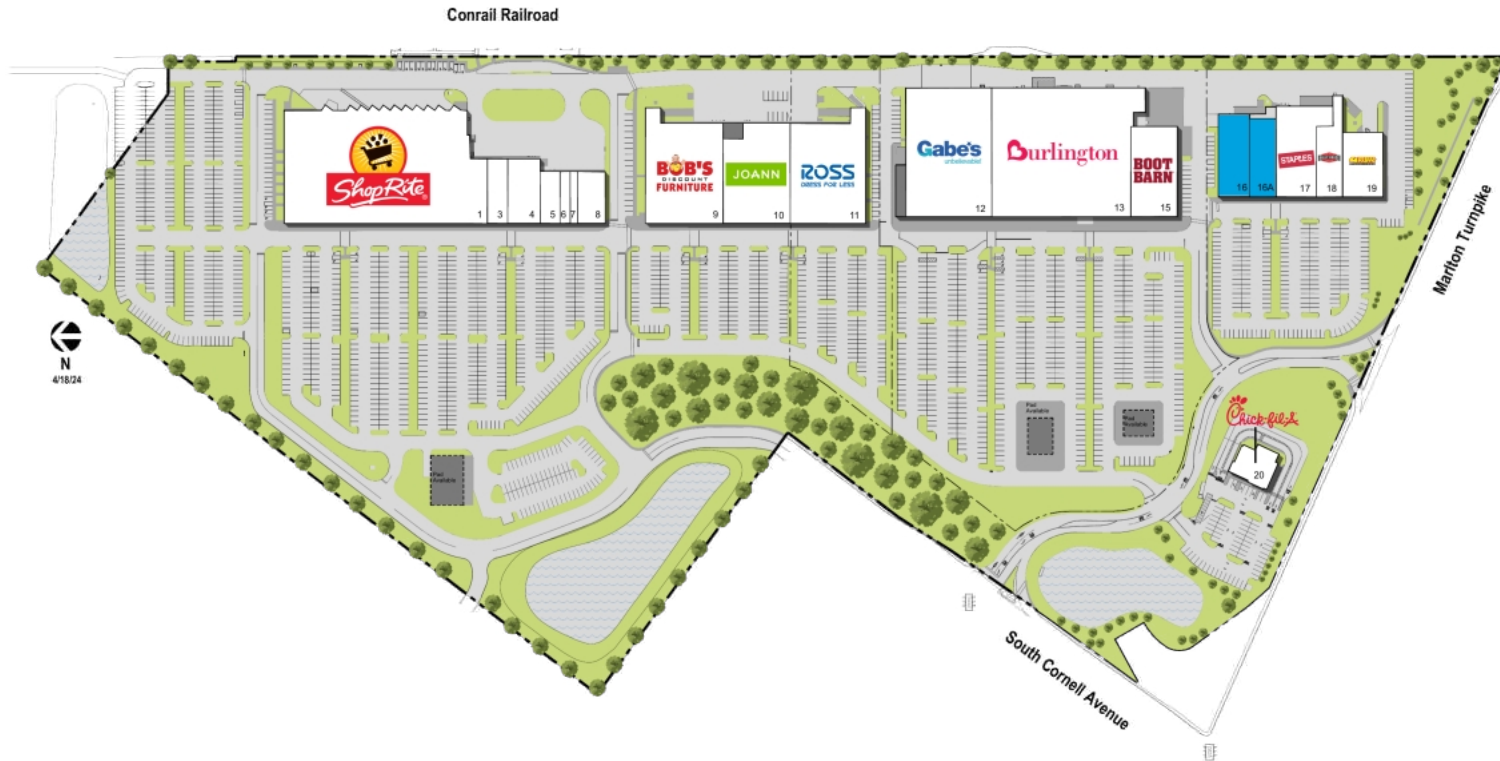

	TENANT	SQ FT
1	ShopRite	86,076
3	Flynn & O'Hara Uniforms	5,000
4	Camden County Democratic Com	750
5	Fitstop	4,000
6	The W Nails & Spa Company, LLC	2,000
7	J. Jean Claude Hair Salon [...]	1,500
8	Phenix Salon Suites	5,500
9	Bob's Discount Furniture	30,711
10	Joann	25,287
11	Ross Dress for Less	30,076
12	Gabe's	39,610
13	Burlington	70,500
15	Boot Barn	15,200
16	Available	9,535
16A	Available	8,494
17	Staples	15,848
18	Rally House New Jersey	7,918
19	4 Wheel Parts	10,000
20	Chick-fil-A	5,147

Disclaimer: This site plan shows the approximate location, square footage, and configuration of the shopping center and adjacent areas, and is only illustrative of the size and relationship of the stores and common areas generally, all of which are subject to change. The showing of any names of tenants, parking spaces, square footage, curb-cuts or traffic controls shall not be deemed to be a representation or warranty that any tenants will be at the shopping center, the square footage is accurate, or that any parking spaces, curb-cuts or traffic controls do or will continue to exist. Moreover, any demographics set forth in this flyer are for illustrative purposes only and shall not be deemed a representation by Landlord or their accuracy. Availability of this property for rent is subject to prior rental or withdrawal of the property from the market at any time without notice.

Michael Reigner

Leasing Representative | (410) 427-4442 | mreigner@kimcorealty.com



Garden State Pavilions

Cherry Hill, NJ

www.kimcorealty.com/116640



COMPETITION MAP

Michael Reigner

Leasing Representative | (410) 427-4442 | mreigner@kimcorealty.com



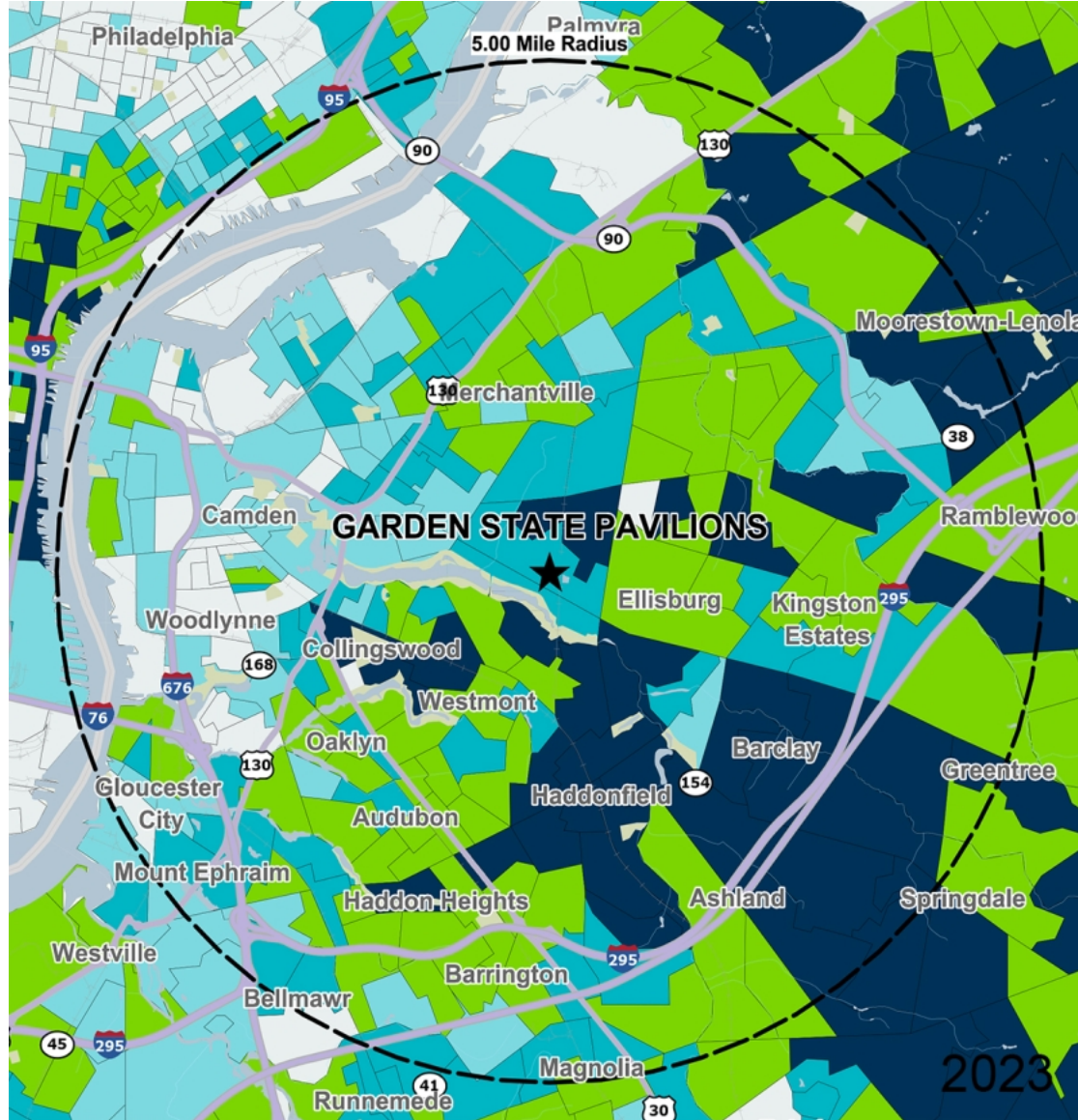

by Block Group

Demographics

2022 ESTIMATES	1-MILE	3-MILES	5-MILES
Population	8,780	150,847	314,152
Daytime Pop	14,344	148,341	341,613
Households	3,525	57,340	117,603
Average HH Income	\$132,066	\$106,598	\$98,703
Median HH Income	\$109,677	\$79,394	\$72,581
Per Capita Income	\$53,314	\$40,744	\$37,265

Average Household Income

Popstats, 4Q 2022, Trade Area Systems

- \$150K and up
- \$100K - \$150K
- \$75K - \$100K
- \$50K - \$75K
- \$0K - \$50K



Michael Reigner

Leasing Representative | (410) 427-4442 | mreigner@kimcorealty.com

Garden State Pavilions

Rt. 70 W & Cornell Ave., Cherry Hill, NJ



Michael Reigner

Leasing Representative

(410) 427-4442

mreigner@kimcorealty.com