



Sunset Point 19 S.C.

Clearwater, FL

Tampa-St. Petersburg-Clearwater (FL)



Spencer Phelps
Leasing Representative
(407) 302-6518
sphelps@kimcorealty.com





AERIAL



GROSS LEASABLE AREA (GLA)

267,819 SF

PARKING SPACES

1,205

Spencer Phelps

Leasing Representative | (407) 302-6518 | sphelps@kimcorealty.com





DENSITY AERIAL

Spencer Phelps

Leasing Representative | (407) 302-6518 | sphelps@kimcorealty.com



■ Non-Controlled

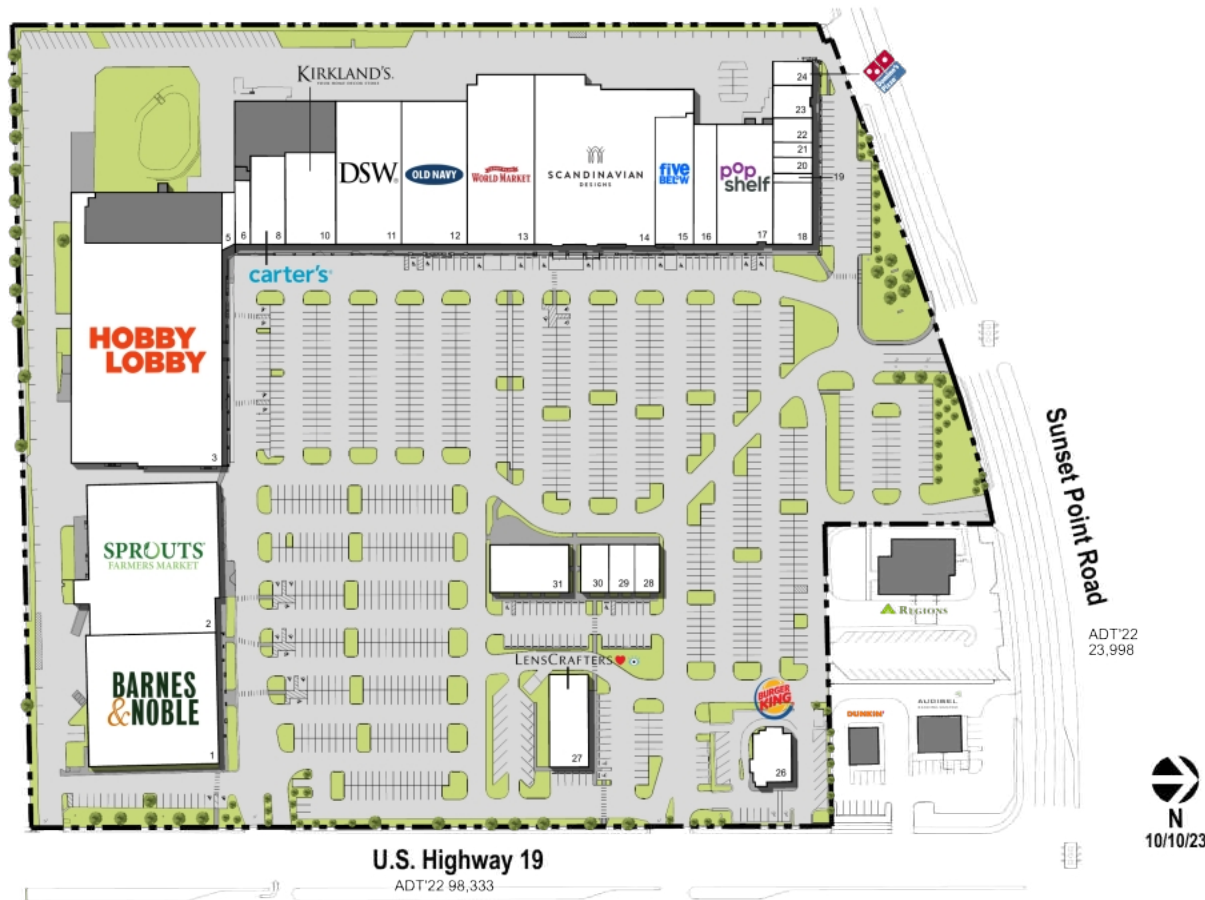

TENANT	SQ FT
1 Barnes & Noble	27,830
2 Sprouts	31,998
3 Hobby Lobby	55,000
5 Idolize	1,098
6 Keep Me In Stitches	1,613
8 Carter's	5,000
10 Kirkland's	7,500
11 DSW Designer Shoe Warehouse	15,300
12 Old Navy Clothing Company	15,300
13 World Market	18,300
14 Scandinavian Design	33,330
15 Five Below	8,050
16 Coast Dental	4,500
17 pOpshelf	10,800
18 Endless Possibilities	4,000
19 Leased	400
20 Sunset Sub Shoppe	1,000
21 Great Clips	1,000
22 H&R Block	1,500
23 Moc Nail Spa	2,000
24 Domino's Pizza	1,500
26 Burger King	3,000
27 LensCrafters	5,800
28 Teriyaki Madness	1,800
29 Golftec	2,138
30 Row House	2,062
31 Mr. & Mrs. Crab Seafood	6,000

Disclaimer: This site plan shows the approximate location, square footage, and configuration of the shopping center and adjacent areas, and is only illustrative of the size and relationship of the stores and common areas generally, all of which are subject to change. The showing of any names of tenants, parking spaces, square footage, curb-cuts or traffic controls shall not be deemed to be a representation or warranty that any tenants will be at the shopping center, the square footage is accurate, or that any parking spaces, curb-cuts or traffic controls do or will continue to exist. Moreover, any demographics set forth in this flyer are for illustrative purposes only and shall not be deemed a representation by Landlord or their accuracy. Availability of this property for rent is subject to prior rental or withdrawal of the property from the market at any time without notice.

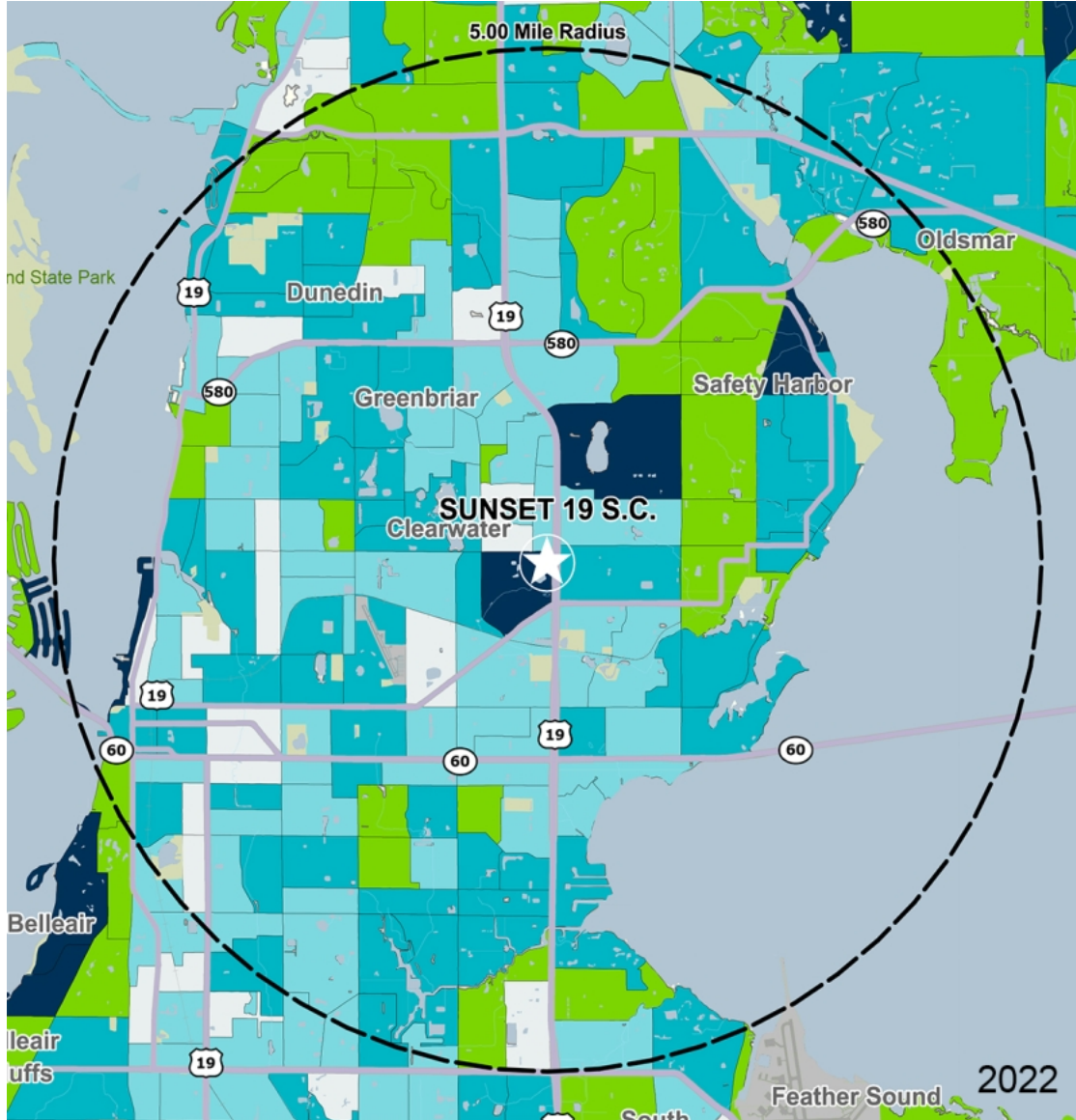

by Block Group

Demographics

2022 ESTIMATES	1-MILE	3-MILES	5-MILES
Population	12,515	102,096	222,632
Daytime Pop	13,511	110,891	228,026
Households	6,184	46,954	100,985
Average HH Income	\$71,944	\$79,558	\$81,117
Median HH Income	\$52,303	\$57,634	\$58,407
Per Capita Income	\$35,750	\$36,957	\$37,483

Average Household Income

Popstats, 4Q 2022, Trade Area Systems

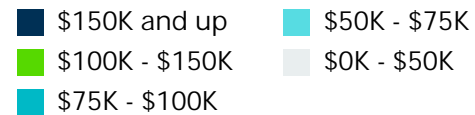

Sunset Point 19 S.C.

US Hwy 19 & Sunset Point Rd., Clearwater, FL



Spencer Phelps

Leasing Representative

(407) 302-6518

sphelps@kimcorealty.com