



# The Green Cove Plaza

Greenvale, NY

New York-Newark-Jersey City (NY-NJ-PA)



**Tom Pira**  
Leasing Representative  
(516) 869-2516  
tpira@kimcorealty.com







AERIAL

GROSS LEASABLE AREA (GLA)

86,446 SF

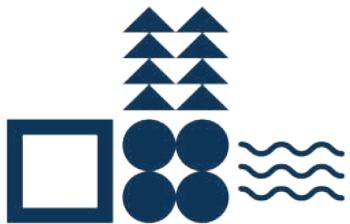

Tom Pira

Leasing Representative | (516) 869-2516 | tpira@kimcorealty.com







DENSITY AERIAL

Tom Pira

Leasing Representative | (516) 869-2516 | [tpira@kimcorealty.com](mailto:tpira@kimcorealty.com)





# The Green Cove Plaza

Greenvale, NY

www.kimcorealty.com/124720

■ Available ■ Potentially Available ■ Non-Controlled

|    | TENANT                   | SQ FT  |
|----|--------------------------|--------|
| 1  | Verizon Wireless         | 1,300  |
| 2  | Stretch Lab              | 1,400  |
| 3  | NEFCU                    | 4,090  |
| 4  | TJ Maxx                  | 30,992 |
| 5  | Available                | 10,646 |
| 6  | Equinox Fitness Club     | 24,000 |
| 7  | Moe's                    | 3,121  |
| 8  | Le French Cleaners       | 1,350  |
| 9  | KungFu Express           | 1,290  |
| 10 | Greenvale Bagels         | 1,350  |
| 11 | European Wax Center      | 1,520  |
| 12 | Marinara Pizza           | 2,800  |
| 13 | QQ Nails & Spa           | 1,350  |
| 14 | European Decorative Arts | 1,237  |

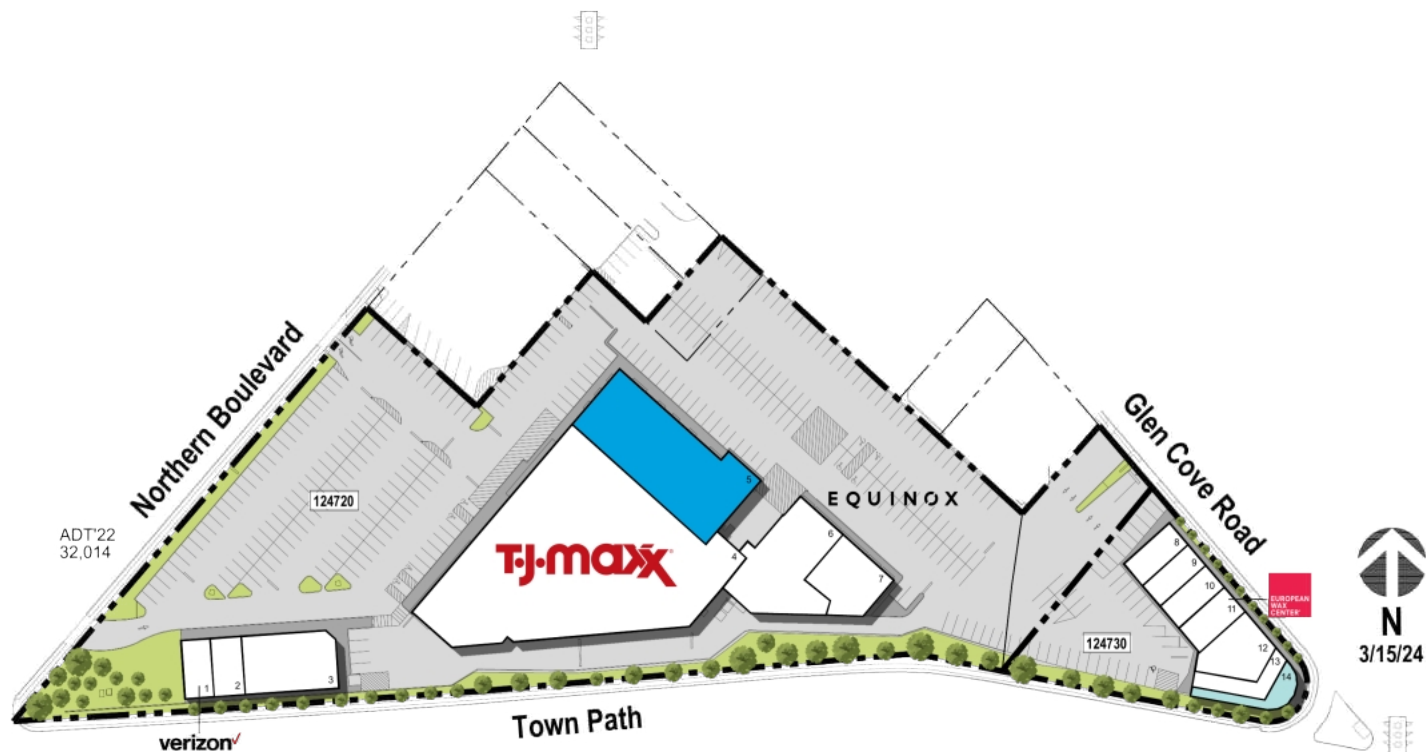

Disclaimer: This site plan shows the approximate location, square footage, and configuration of the shopping center and adjacent areas, and is only illustrative of the size and relationship of the stores and common areas generally, all of which are subject to change. The showing of any names of tenants, parking spaces, square footage, curb-cuts or traffic controls shall not be deemed to be a representation or warranty that any tenants will be at the shopping center, the square footage is accurate, or that any parking spaces, curb-cuts or traffic controls do or will continue to exist. Moreover, any demographics set forth in this flyer are for illustrative purposes only and shall not be deemed a representation by Landlord or their accuracy. Availability of this property for rent is subject to prior rental or withdrawal of the property from the market at any time without notice.

Tom Pira

Leasing Representative | (516) 869-2516 | tpira@kimcorealty.com



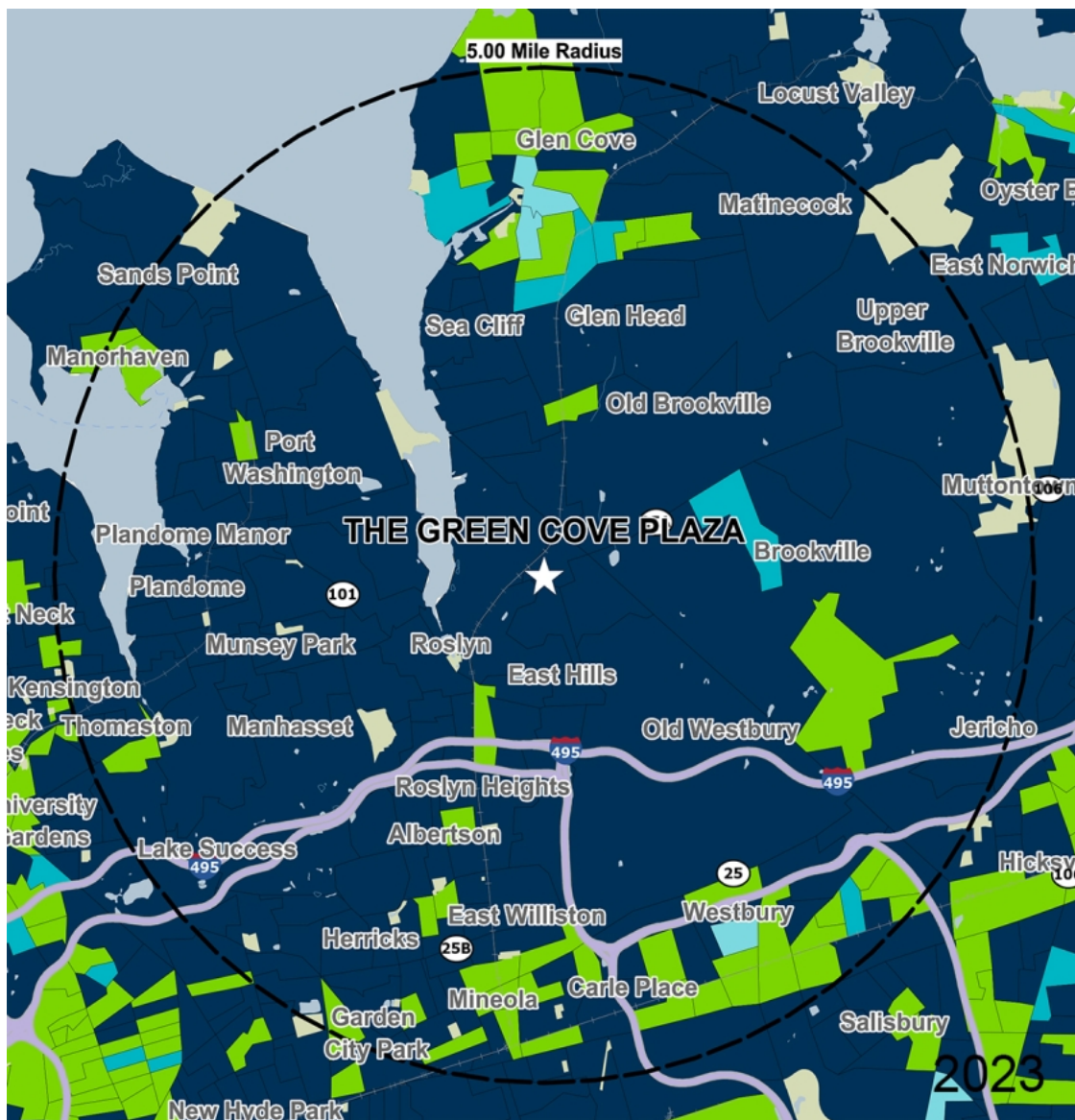

by Block Group

## Demographics

| 2022 ESTIMATES    | 1-MILE    | 3-MILES   | 5-MILES   |
|-------------------|-----------|-----------|-----------|
| Population        | 6,055     | 59,175    | 235,284   |
| Daytime Pop       | 11,718    | 93,318    | 349,629   |
| Households        | 2,004     | 20,028    | 80,510    |
| Average HH Income | \$316,587 | \$263,525 | \$201,809 |
| Median HH Income  | \$182,317 | \$167,096 | \$136,155 |
| Per Capita Income | \$104,759 | \$90,111  | \$70,000  |

## Average Household Income

Popstats, 4Q 2022, Trade Area Systems

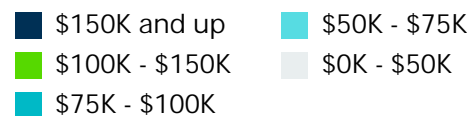

Tom Pira

Leasing Representative | (516) 869-2516 | tpira@kimcorealty.com

# The Green Cove Plaza

Northern Blvd. & Glen Cove Rd., Greenvale, NY



**Tom Pira**  
Leasing Representative  
(516) 869-2516  
tpira@kimcorealty.com