



South Pasadena S.C.

South Pasadena, FL

Tampa-St. Petersburg-Clearwater (FL)



Spencer Phelps
Leasing Representative
(407) 302-6518
sphelps@kimcorealty.com





DENSITY AERIAL

Spencer Phelps

Leasing Representative | (407) 302-6518 | sphelps@kimcorealty.com



Available

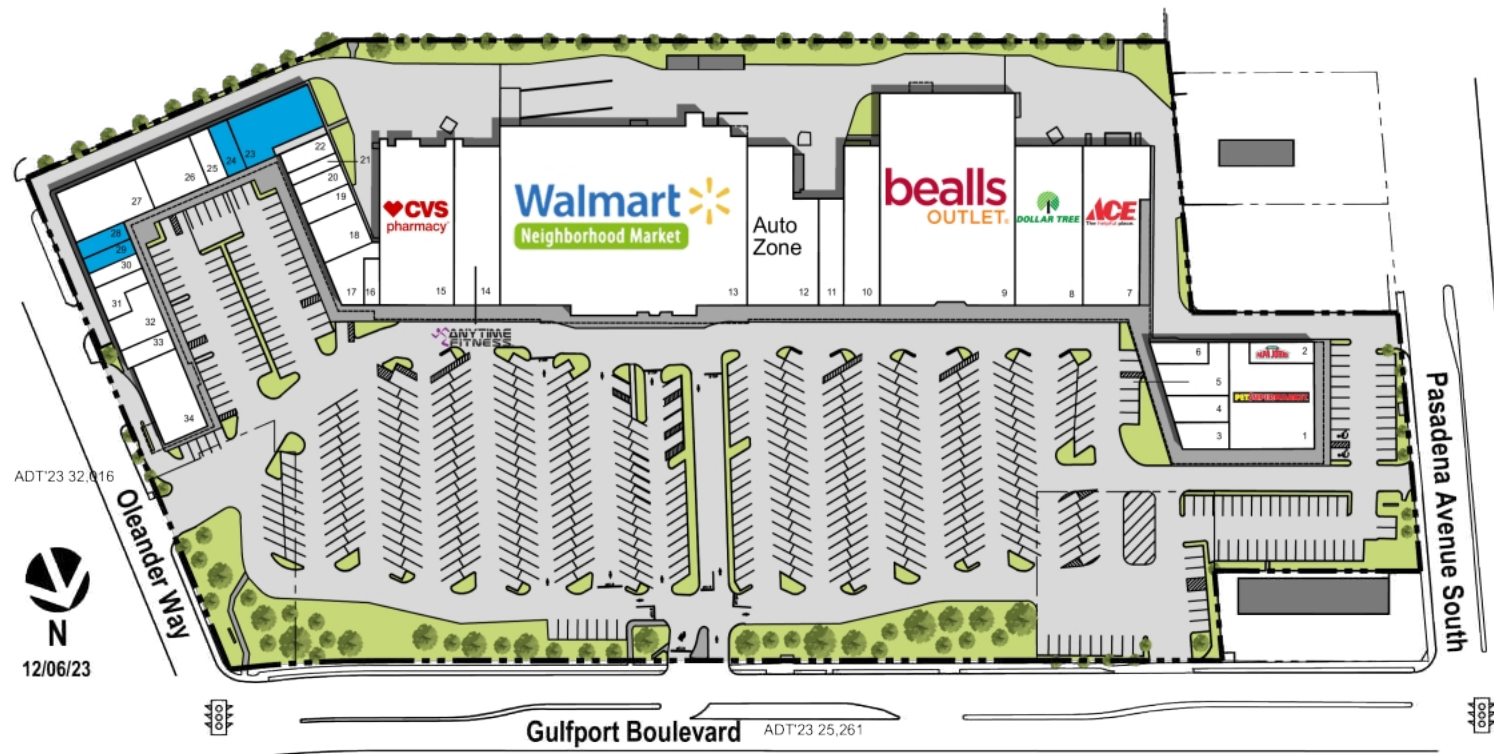

TENANT	SQ FT
1 Pet Supermarket	7,420
2 Papa Johns	1,519
3 Fortunato's	1,524
4 HI 5 Tobacco Vapor	814
5 Coast Dental	2,619
6 Esquire Barber	360
7 ACE Hardware	11,000
8 Dollar Tree	7,500
9 Bealls Outlet	26,250
10 Keke's Breakfast Cafe	5,000
11 Pasadena Jewelers	2,000
12 AutoZone	9,750
13 Walmart Neighborhood Market	41,884
14 Anytime Fitness	5,271
15 CVS	12,000
16 Fantastic Sams	875
17 Club Pilates	1,750
18 Poke Falls	2,000
19 Beltone Hearing Aid Services	900
20 OsteoStrong	1,000
21 Joy's Doggery	750
22 RE/MAX	750
23 Available	3,810
24 Available	1,000
25 The UPS Store	1,000
26 Quest Diagnostics	2,850
27 Books At Park Place	2,100
28 Available	875
29 Available	750
30 MetroPCS	750
31 Asian House Restaurant	1,152
32 H&R Block	1,923
33 Nails N Nails	1,000
34 GTS Medical	3,600

Disclaimer: This site plan shows the approximate location, square footage, and configuration of the shopping center and adjacent areas, and is only illustrative of the size and relationship of the stores and common areas generally, all of which are subject to change. The showing of any names of tenants, parking spaces, square footage, curb-cuts or traffic controls shall not be deemed to be a representation or warranty that any tenants will be at the shopping center, the square footage is accurate, or that any parking spaces, curb-cuts or traffic controls do or will continue to exist. Moreover, any demographics set forth in this flyer are for illustrative purposes only and shall not be deemed a representation by Landlord or their accuracy. Availability of this property for rent is subject to prior rental or withdrawal of the property from the market at any time without notice.

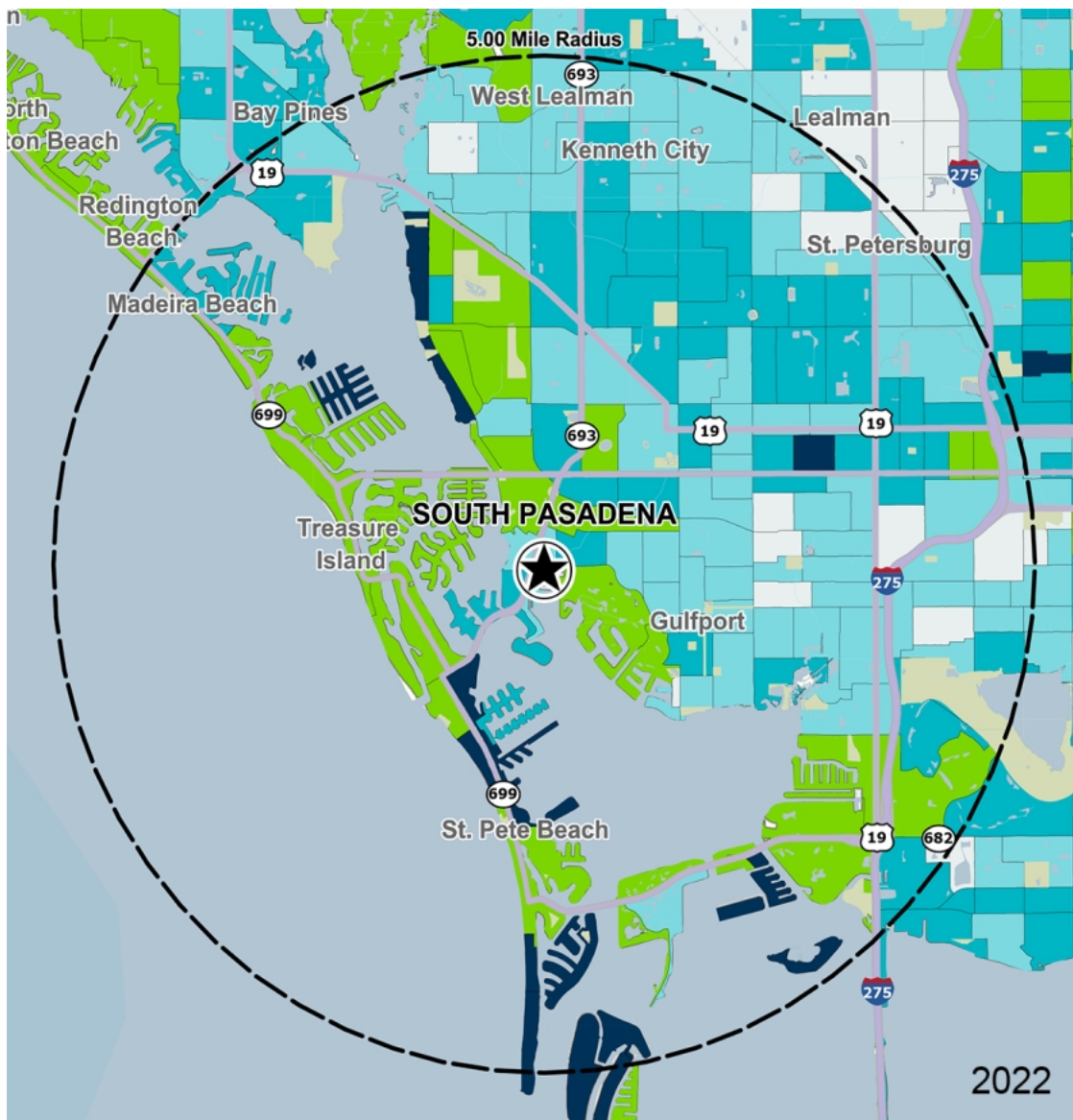

by Block Group

Demographics

2022 ESTIMATES	1-MILE	3-MILES	5-MILES
Population	10,549	71,446	180,603
Daytime Pop	9,920	71,400	178,069
Households	5,800	34,072	81,551
Average HH Income	\$84,585	\$90,642	\$85,667
Median HH Income	\$57,162	\$65,134	\$62,153
Per Capita Income	\$47,537	\$43,721	\$39,270

Average Household Income

Popstats, 4Q 2022, Trade Area Systems

- \$150K and up
- \$100K - \$150K
- \$75K - \$100K
- \$50K - \$75K
- \$0K - \$50K



South Pasadena S.C.

Gulfport Blvd. S& Pasadena Ave. S, South Pasadena, FL



Spencer Phelps

Leasing Representative

(407) 302-6518

sphelps@kimcorealty.com